

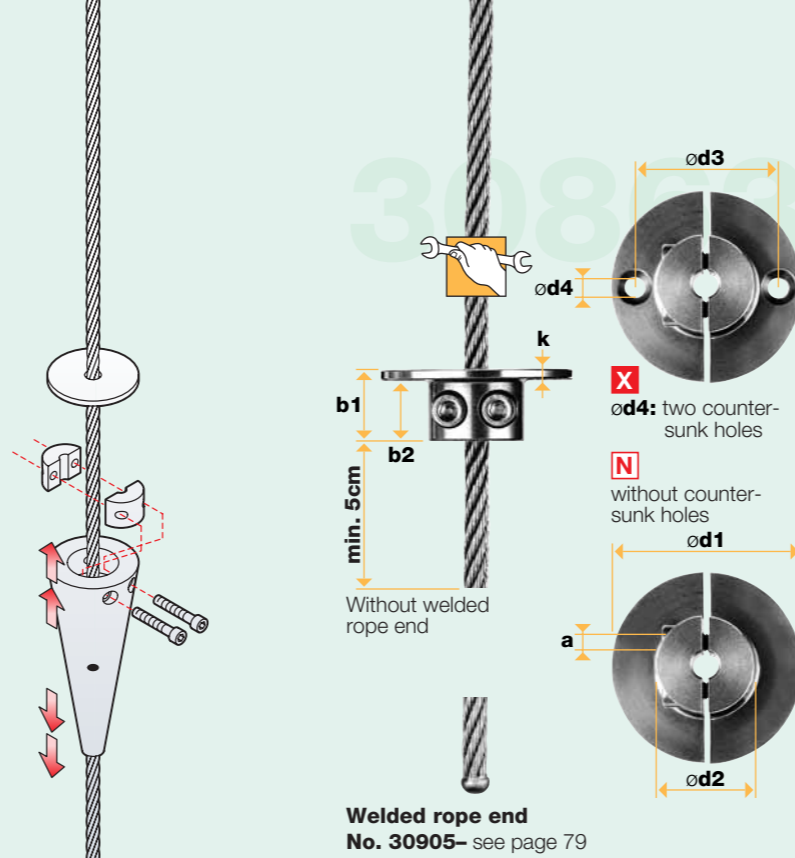

82.A

82.C

82.B



**Degreasing** the parts and the wire rope increases the permissible **axial force** (kN)!  
 Not suitable for stranded wire rope  
**No.10810-**

Not suitable for stranded wire rope  
**No.10810-**

**The user is responsible** for choosing the proper rope  $\od$  and for correct assembly. Functionality is guaranteed only by Jakob rope **No. 10820-** with code filament.

Technical data subject to change. All rights reserved. © 1988 / 02 by Jakob AG Switzerland. Rev. 2

2-PART FLANGE RING

Patent pending

1.4305  
AISI 303

no. X	no. N	$\od$ mm	a	max. axial force kN	b1	b2	$\od d1$	$\od d2$	$\od d3$	$\od d4$	k
30863-	30863-	2,0	M3	0,350	11	9,5	30	15	22,5	3,2	1,5
0300-01	0300-02	3,0	M3	0,375	11	9,5	30	15	22,5	3,2	1,5
0400-01	0400-02	4,0	M3	0,400	11	9,5	30	15	22,5	3,2	1,5
0500-01	0500-02	5,0	M4	0,425	11	9,5	35	20	27,5	3,2	1,5
0600-01	0600-02	6,0	M4	0,450	11	9,5	35	20	27,5	3,2	1,5
0800-01	0800-02	8,0	M4	0,500	11	9,5	35	20	27,5	3,2	1,5

kN x 102 = kp

**Degreasing** the parts and the wire rope increases the permissible **axial force** (kN)!  
 Not suitable for stranded wire rope  
**No.10810-**

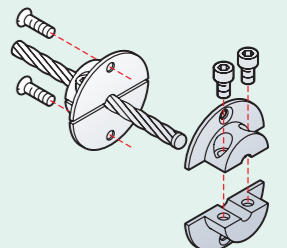

COVER DISK FOR WIRE ROPE CLAMPING CONE

1.4305  
AISI 303

no.	$\od$ mm	$\od d1$	$\od d2$	k
30859-	3,0	30	3,5	4
0300-031	3,0	30	3,5	4
0400-031	4,0	30	4,5	4

WIRE ROPE CLAMPING CONE, SCREWED

1.4305  
AISI 303

For on-site assembly with rope **No. 10820-**  
 Other executions see NEWS catalogue.

no.	$\od$ mm	max. axial force kN	b	$\od d$
30859-	3,0	0,375	90	30
0300-03	3,0	0,375	90	30
0400-03	4,0	0,400	90	30

kN x 102 = kp

WIRE ROPE CONE WITH DISK, SCREWED

1.4305  
AISI 303

For on-site assembly with rope **No. 10820-** / Patent/DBGM pending  
 Breaking strength: 90% of min. rope breaking load

no.	$\od$ mm	b1	b2	b3 max.	b4	$\od d1$	$\od d2$	k	sw
30859-	3,0	114(+b3)	90	15	18	30	14,8	6	13
0300-02	3,0	114(+b3)	90	15	18	30	14,8	6	13
0400-02	4,0	114(+b3)	90	15	18	30	14,8	6	13

Technical data subject to change. All rights reserved. © 1988 / 96 by Jakob AG Switzerland.