

Externally insulated façades
The spacer is mounted on an insulated support tube and thus transfers lateral forces to the substrate (see Figs. A to F).

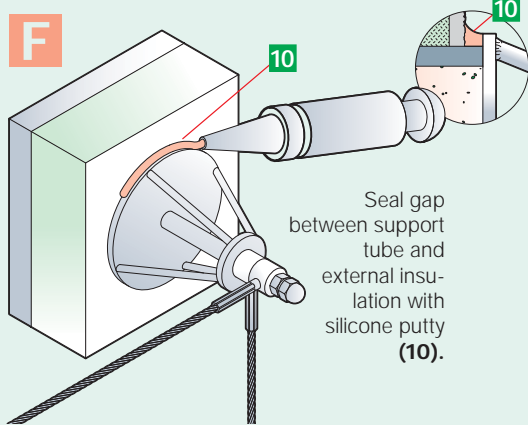

Technical data subject to change.
All rights reserved. © 1988 / 02 by Jakob AG Switzerland. Rev. 2

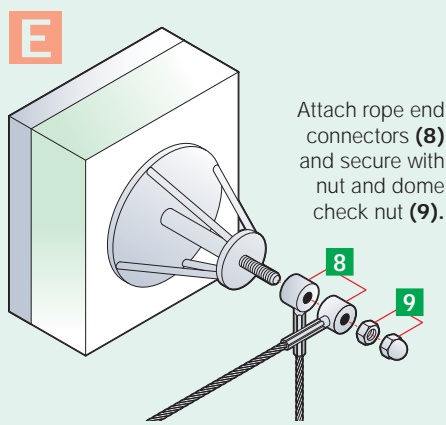
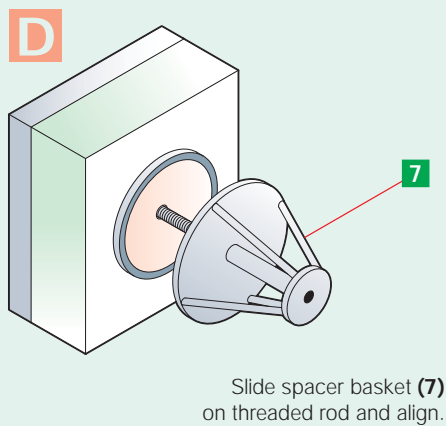
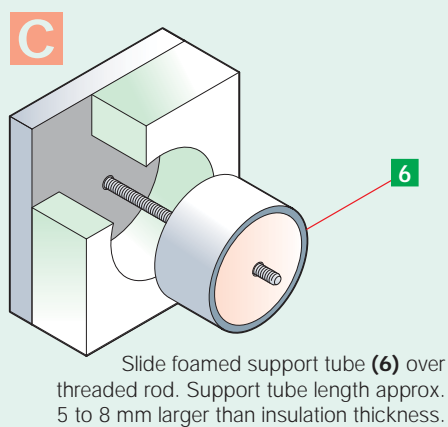
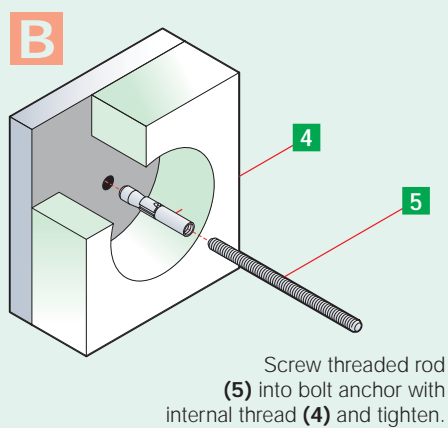
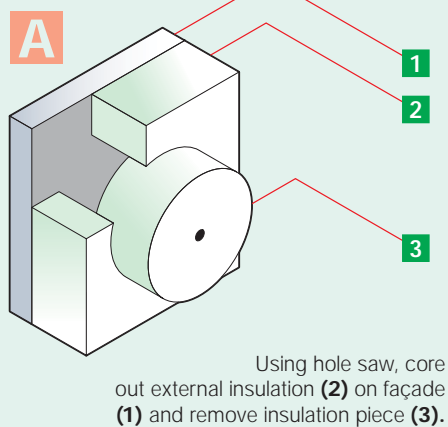

90.A

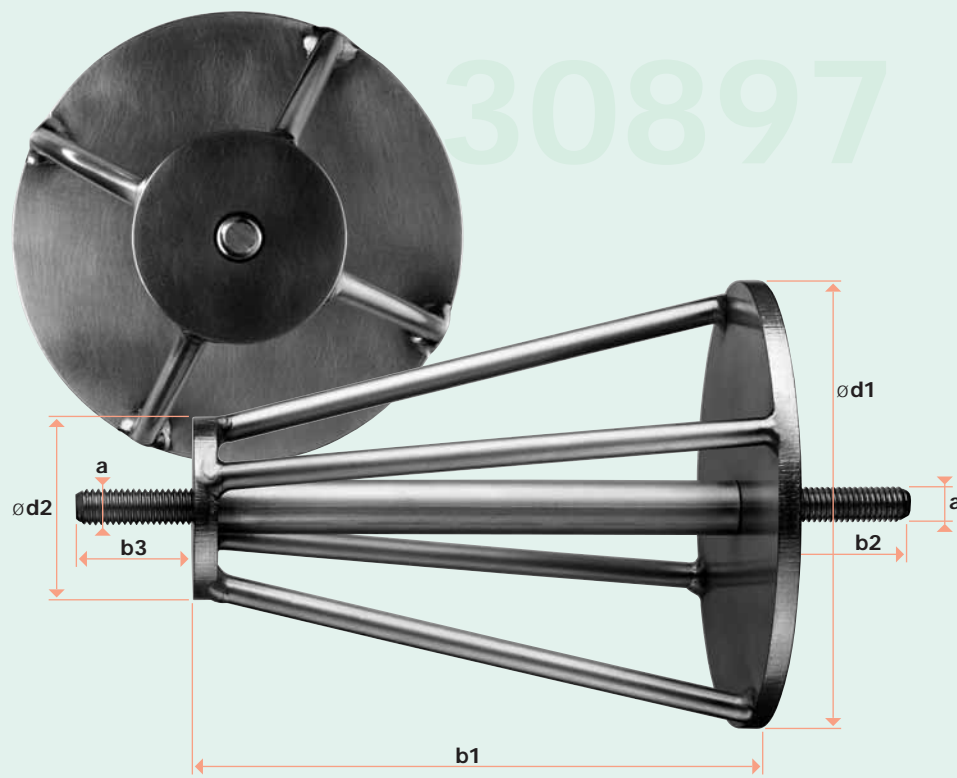

30897

30897

30897

SPACER BASKET FOR WIRE ROPE GUIDES

Europ. patent pending

30897-	a	b1	b2	b3	ø d1	ø d2
0075	M8	75	variable	variable	100	40
0100	M8	100	↑	↑	100	40
0150	M8	150	↑	↑	100	40
0200	M8	200	↑	↑	100	40

When ordering, indicate dimensions b2 and b3!

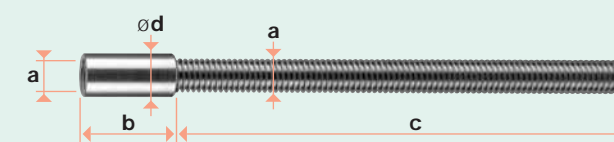

THREADED EXTENDER

Right-hand thread

30919-	a	b	c	ø d
0800-05	M8	20	variable	10

When ordering indicate dimension c!

SUPPORT TUBE

Patent / DBGM pending

30897-	b	ø d1	ø d2	ø d3
0020-10 foam-filled	variable	11	78	90
0020-11 unfilled	indicate when ordering	-	58	90

Costs for cut and drilling: No. 30897-0020-01



Correct assembly is the responsibility of the user. **Strength ratings** and permissible loads based on the application must be calculated by a statics specialist.

Technical data subject to change.
All rights reserved. © 1988 / 03 by Jakob AG Switzerland. Rev. 3

13

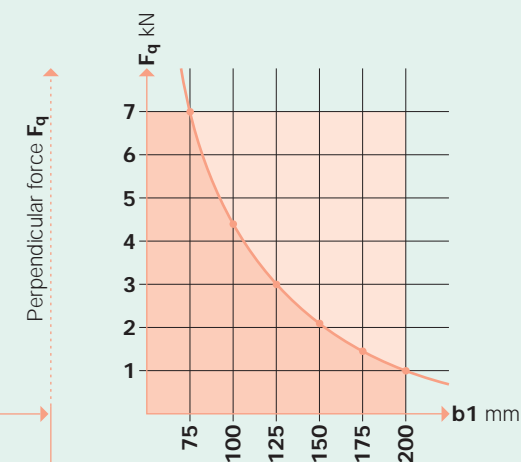
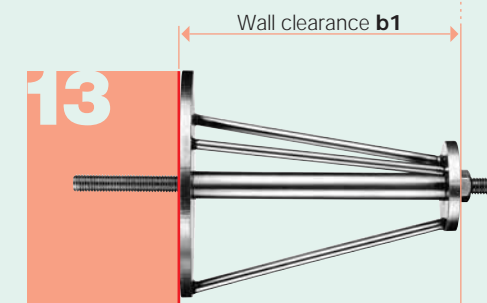

Diagram:
Load which causes permanent deformation of spacer basket anchored to a rigid structure.